

Aluminium Internal
Corner mould

Timber cavity battens

Flexible underlay

Trimline internal corner
jointer

Apply two 6mm thick lines
of adhesive sealant on
the bottom portion of the
Hardie™ 14mm
aluminium trimline joint to
seal

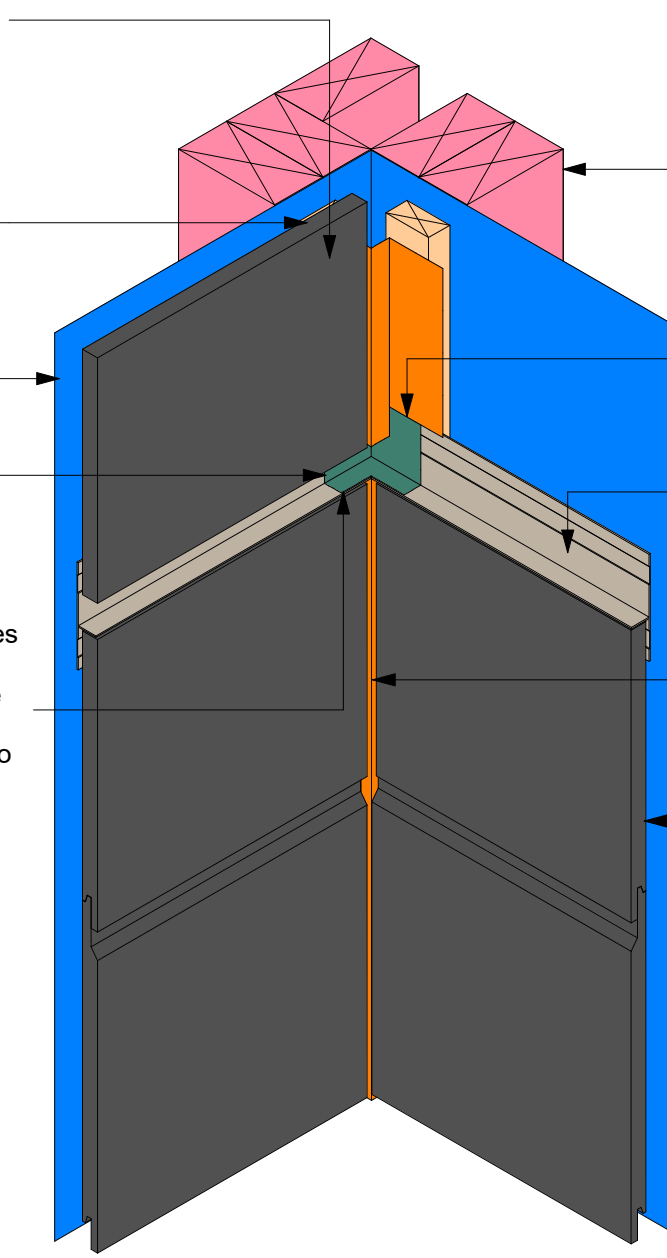

Framing

Cut back leg of flashing
to avoid build up.

Oblique™ Weatherboard
Trimline joint flashing

Flexible silicone sealant

Oblique™ Weatherboard to
be primed prior to flashing
installation