

Hardie™ 14mm Aluminium
Internal Corner mould

Timber cavity battens

Flexible underlay

Apply two 6mm thick lines
of adhesive sealant on
the bottom portion of the
Hardie™ 14mm aluminium
trimline joint to seal

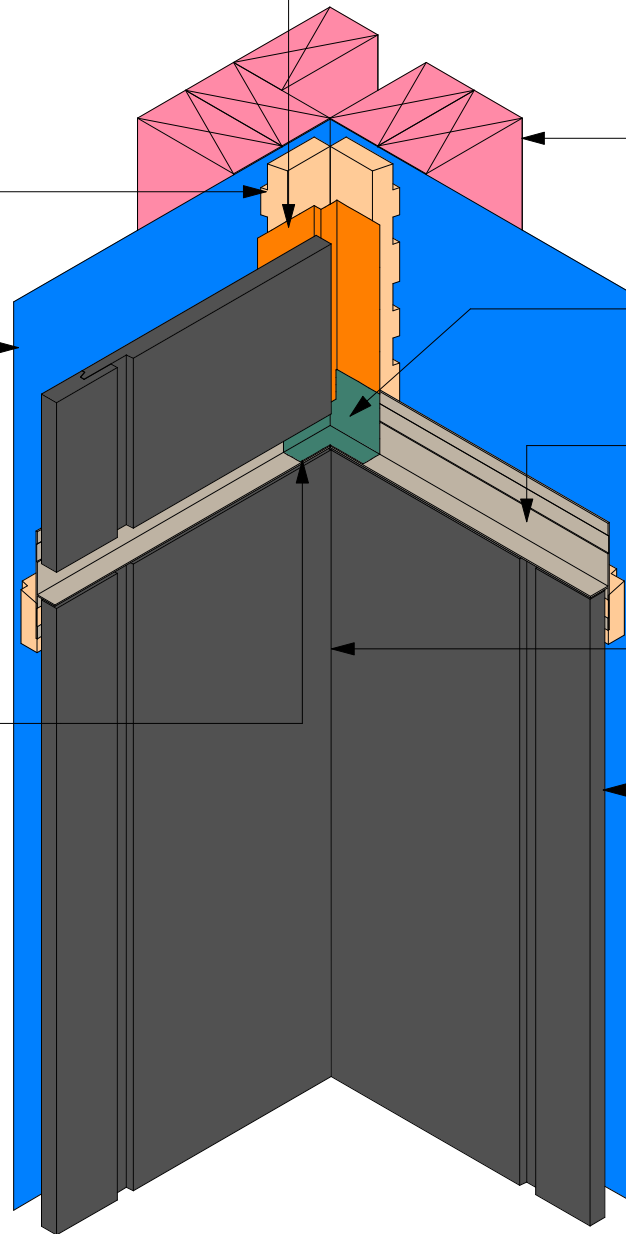

Framing

Cut the back flange of internal
corner mould to avoid build up.
Seal the flashing junctions
using flashing tape

Hardie™ 14mm Cladding
Trimline joint flashing

Flexible silicone sealant

Stria™ Cladding to be primed
prior to flashing installation