

Hardie™ 14mm Aluminium
Internal Corner mould

Timber cavity battens

Flexible underlay

Trimline internal corner
jointer

Apply two 6mm thick lines
of adhesive sealant on
the bottom portion of the
Hardie™ 14mm aluminium
trimline joint to seal

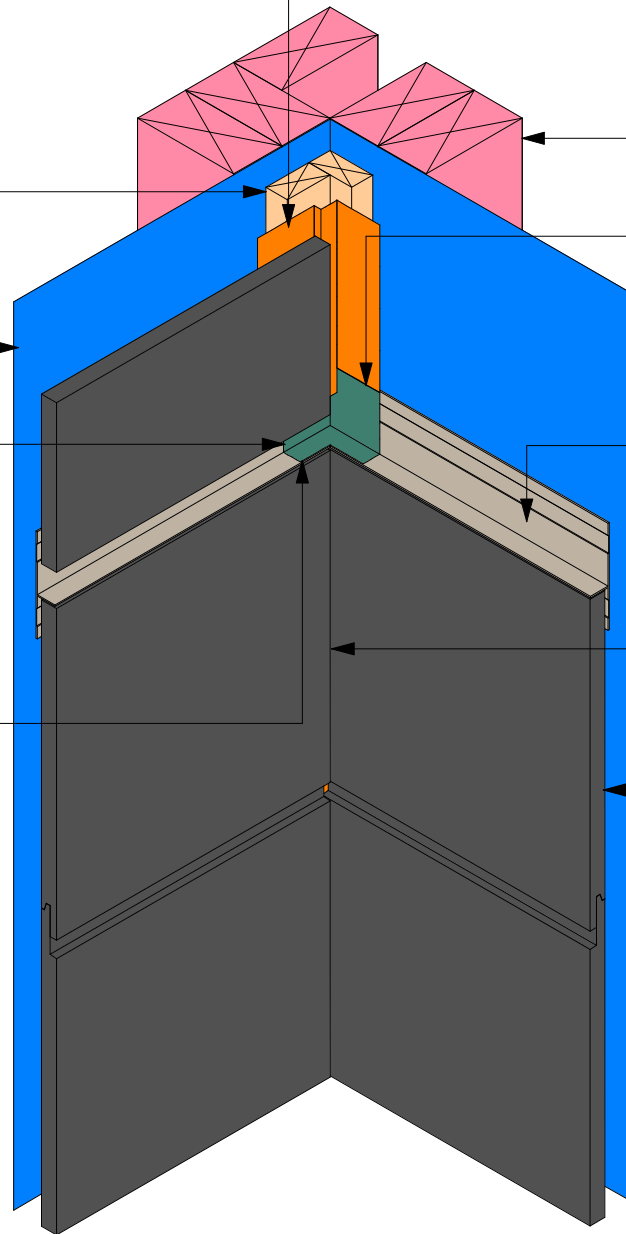

Framing

Cut the back flange of
internal corner mould to
avoid build up. Seal the
flashing junctions using
flashing tape

Hardie™ 14mm trimline
joint flashing

Flexible silicone sealant

Stria™ Cladding to be primed
prior to flashing installation